

## LOBBY LEVEL

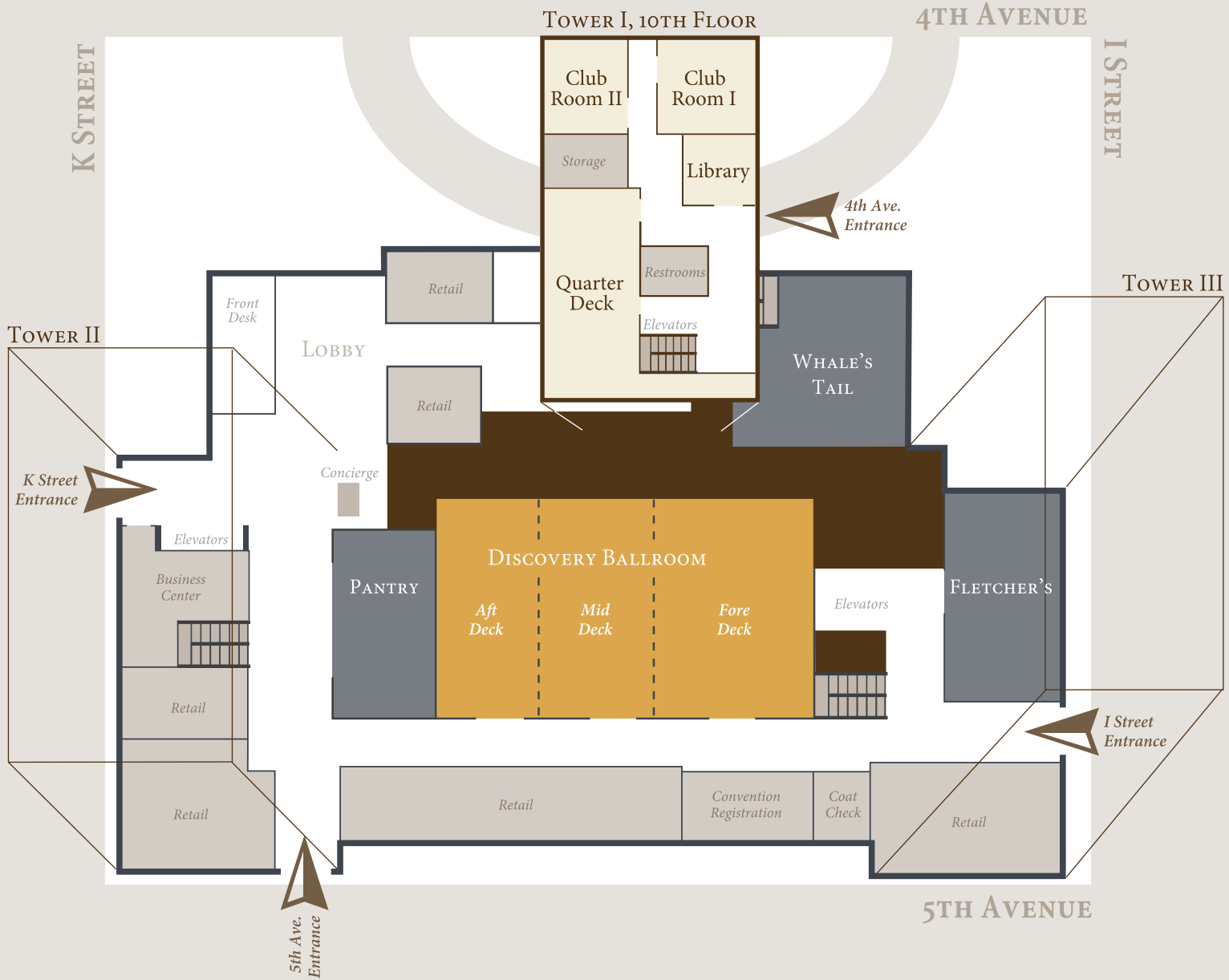

|                    | THEATRE | TABLE* | RECEPTION | CLASSROOM | SQ. FEET | WIDTH | LENGTH | CEILING |
|--------------------|---------|--------|-----------|-----------|----------|-------|--------|---------|
| Discovery Ballroom | 1250    | 770    | 1000      | 500       | 9000     | 120'  | 75'    | 17'     |
| Fore Deck          | 500     | 300    | 500       | 250       | 3975     | 53'   | 75'    | 17'     |
| Mid Deck           | 350     | 210    | 300       | 150       | 2700     | 36'   | 75'    | 17'     |
| Aft Deck           | 200     | 180    | 200       | 100       | 2325     | 31'   | 75'    | 17'     |
| Quarter Deck       | 75      | 90     | 150       | 30        | 1989     | 27'   | 67'    | 7'6"    |
| Club Room I        | 50      | 30     | 40        | 20        | 700      | 20'   | 35'    | 8'      |
| Club Room II       | 50      | 40     | 40        | 20        | 595      | 17'   | 35'    | 8'      |
| Library            |         | 10     | 10        |           | 288      | 12'   | 24'    | 8'      |

\* round tables seat 10

## LOWER LOBBY LEVEL

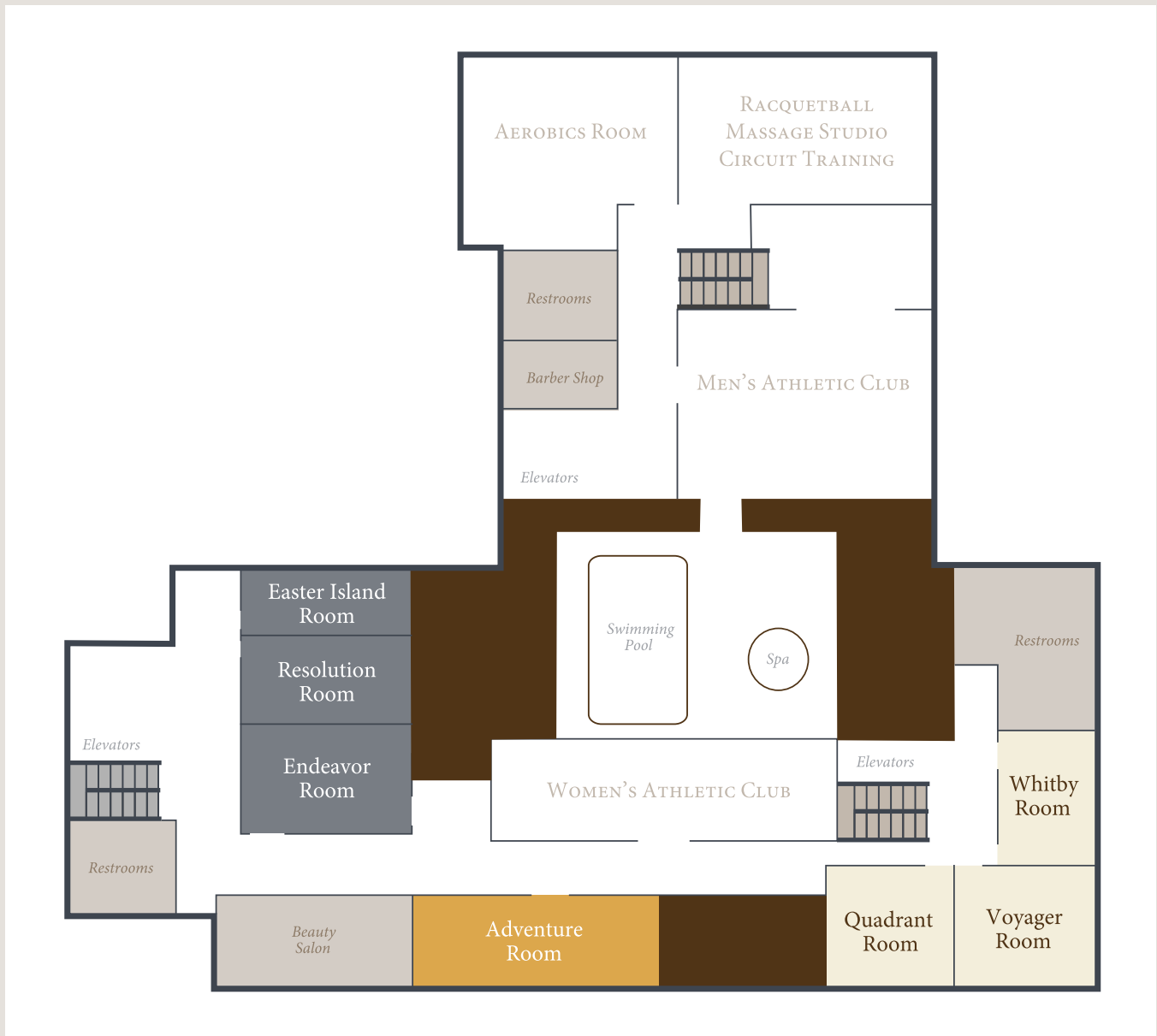

|                    | THEATRE | TABLE* | RECEPTION | CLASSROOM | SQ. FEET | WIDTH | LENGTH | CEILING |
|--------------------|---------|--------|-----------|-----------|----------|-------|--------|---------|
| Easter Island Room | 54      | 40     | 75        | 27        | 544      | 16'   | 34'    | 9'      |
| Resolution Room    | 54      | 40     | 75        | 27        | 544      | 16'   | 34'    | 9'      |
| Endeavor Room      | 150     | 120    | 200       | 70        | 1591     | 43'   | 37'    | 9'      |
| Adventure Room     | 110     | 60     | 150       | 50        | 1071     | 21'   | 51'    | 10'     |
| Quadrant Room      | 65      | 50     | 125       | 30        | 988      | 26'   | 38'    | 8'      |
| Voyager Room       | 58      | 40     | 85        | 28        | 646      | 17'   | 38'    | 9'4"    |
| Whitby Room        | 50      | 30     | 65        | 26        | 551      | 19'   | 29'    | 9'4"    |

\* round tables seat 10